

WARNING!

Avoid Damage to Your Display

•••Read all instructions below•••

Pack and Unpack Carefully

Check for caught skins.



PROPER WAY



Check for twisted skins.

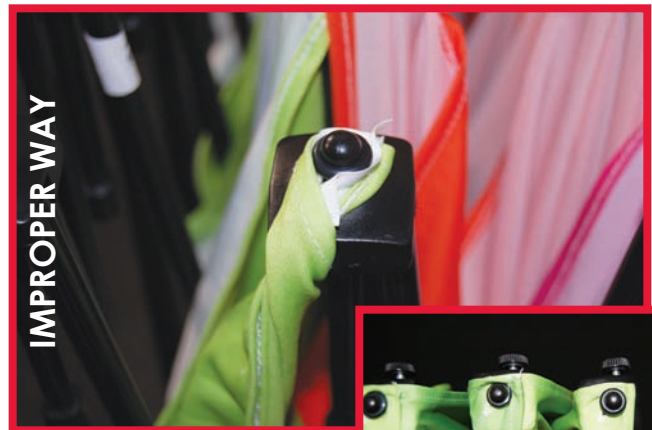

PROPER WAY



opening/closing instructions

Opening Xpressions™ Frame:

1. Take frame from box, Lay frame in front of you with the red hubs on the floor.
2. Make sure all skins are straight around the button holes
3. Take hold of the frame and carefully pull the frame up.
4. Snap all connectors into place.

Closing Xpressions™ Frame:

1. Unsnap all connectors
2. Slowly lower frame to the floor
3. Turn frame so front side is facing upward and tuck in all skins making sure they are straight at button holes.
4. For skins on the opposite side (back dimension) of the frame, turn frame over straighten as best you can and let the skins fall to one side.

Care Instructions

Machine wash cold or warm. Do not use bleach. Tumble dry low setting. Do not exceed 120°. Remove immediately to prevent wrinkling. Do not iron directly on logo, iron on backside of image Meets: NFPA#701

xpressions

PLEASE READ CAREFULLY BEFORE SETTING UP YOUR DISPLAY!

xpressions **SNAP!**

AVOID DAMAGE TO YOUR DISPLAY, USE PROPER SET-UP PROCEDURE.
ONE PERSON SET-UP

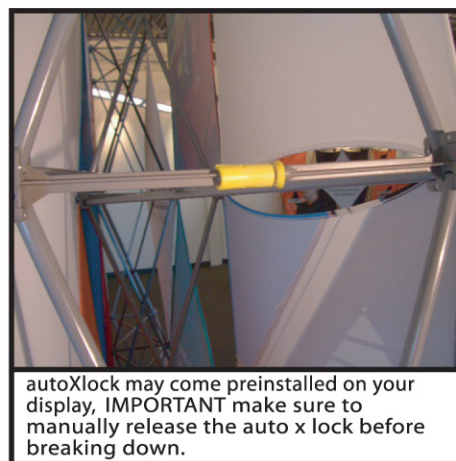
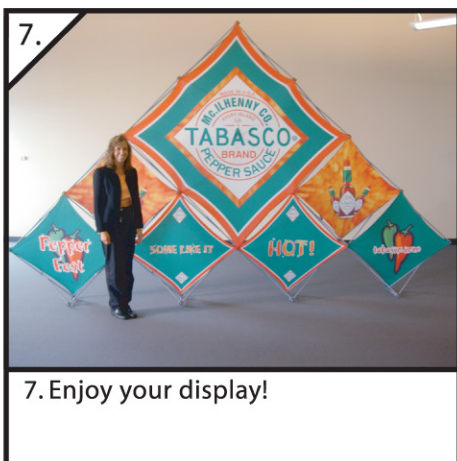
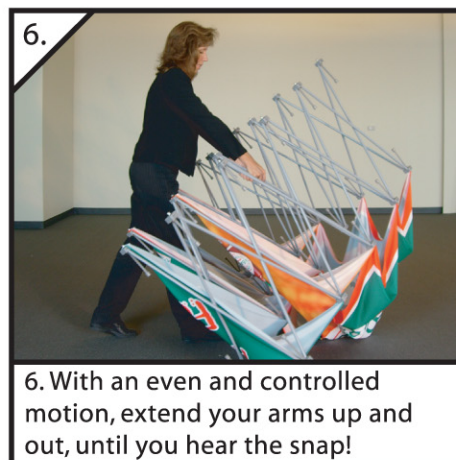
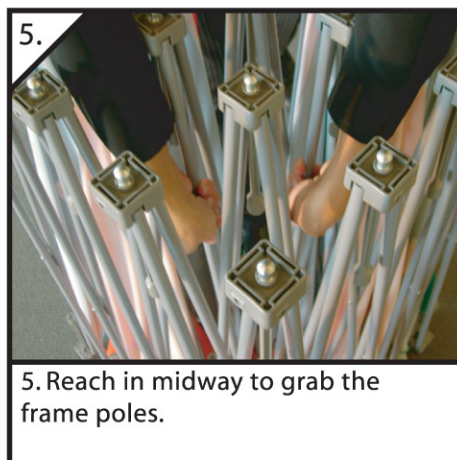
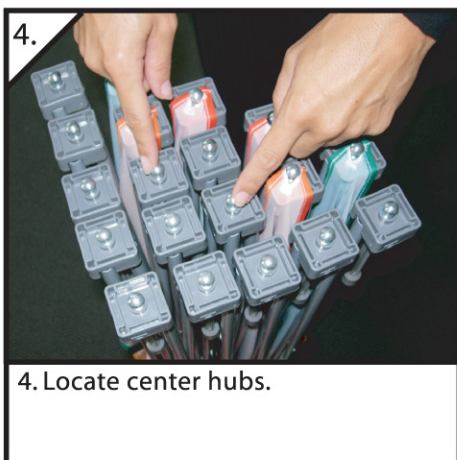
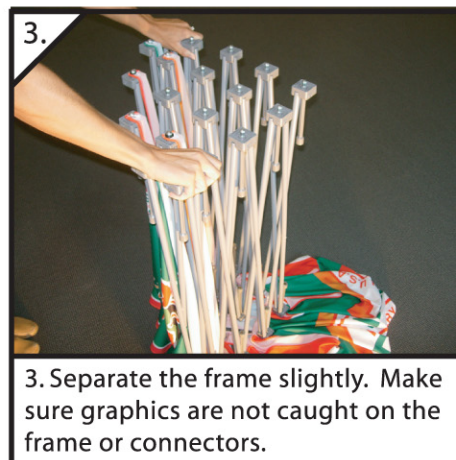
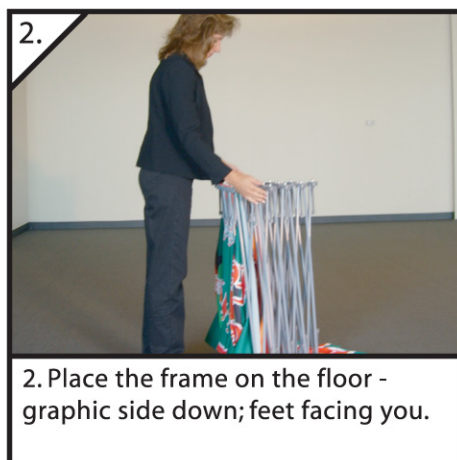
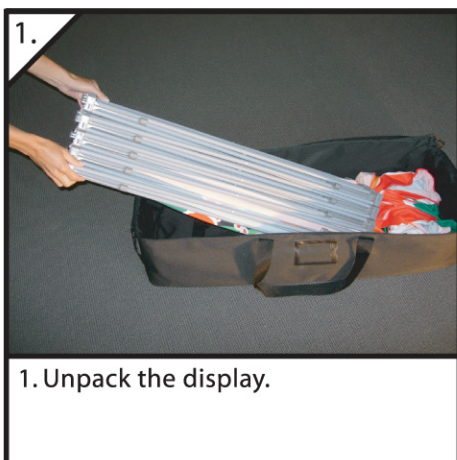

For More Information Visit [www.xpressions-snap.com / help and support / tutorials](http://www.xpressions-snap.com/help-and-support/tutorials).

PLEASE READ CAREFULLY BEFORE SETTING UP YOUR DISPLAY!

xpressions **SNAP!**

AVOID DAMAGE TO YOUR DISPLAY, USE PROPER SET-UP PROCEDURE.

TWO PERSON SET.UP

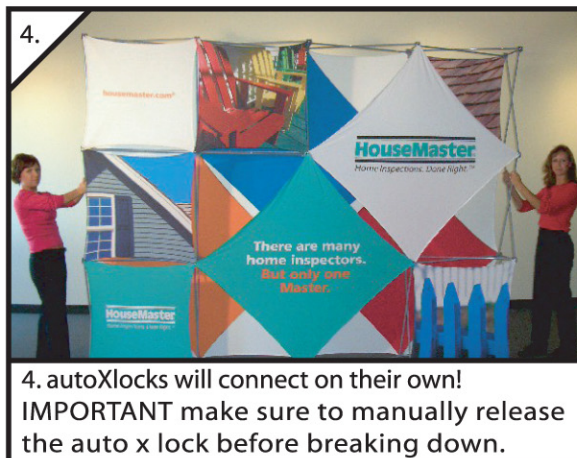
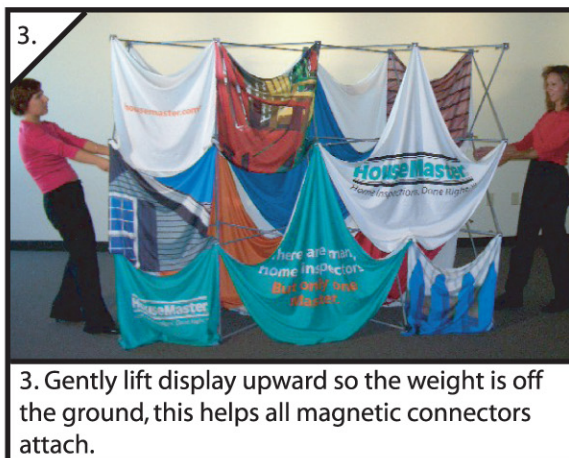
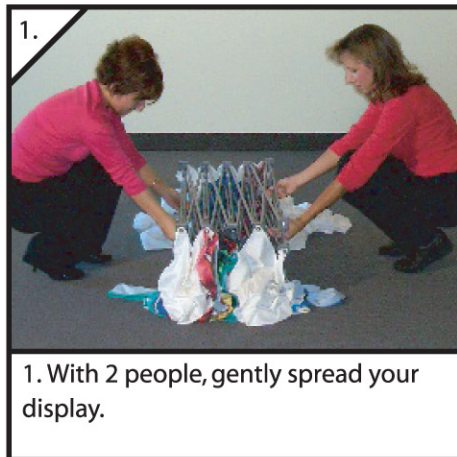

For More Information Visit www.xpressions-snap.com / help and support / tutorials.